

Rev	Description	Date
1	Issued for Fire Safety Plan revision	25/03/15
2	As-Built Updates	05/09/19
3	Issued for Fire Safety Plan revision	10/10/19
4	Update Tenant Useable Office Area	26/07/21

Legends / Notes:
 1. THIS DRAWING HAS BEEN PREPARED FOR THE EXCLUSIVE USE OF RENESAS. FOR PURPOSES OF CONCEPTUAL PLAN DEVELOPMENT ONLY AND ANY THIRD PARTY USE OF THESE DRAWINGS BEYOND THIS ORIGINAL PURPOSE SHOULD BE VERIFIED FOR CONTENT AND ACCURACY

- GROSS BUILDING AREA
 - MAJOR VERTICAL PENETRATION
 - GROSS MEASURED AREA
 - BUILDING COMMON AREA
 - FLOOR COMMON AREA
 - OFFICE AREA
- RENESAS
 - FUTURE RENESAS
 - UNASSIGNED
 - BUILDING COMMON
 - VERTICAL PENETRATION
 - FLOOR COMMON

DISCLAIMER:
 THIS DRAWING HAS BEEN PREPARED OVER A PERIOD OF MANY YEARS, ON AN AD HOC BASIS TO MEET THE NEEDS OR PURPOSES OF THE DAY, IS INCOMPLETE AND HAS NOT BEEN CROSS-CHECKED TO GENERALLY ACCEPTED PRINCIPLES OF VERIFICATION.
 TENANT AREA MEASUREMENTS HAVE BEEN CALCULATED BASED ON THE FOLLOWING PRINCIPLES OF MEASUREMENT:
 - EXCLUSIVE OF BUILDING AND FLOOR COMMON AND VERTICAL PENETRATION ASSIGNED SPACES, INCLUDING THE WALLS THAT ENCOMPASS THEM
 - TO CENTRELINE OF SHARED DEMISING WALLS.
 - TO GLASS WHERE VERTICAL HEIGHT IS GREATER THAN FIFTY PERCENT IN VERTICAL HEIGHT.
 - TO INSIDE FACE OF OUTSIDE PERIMETER WALLS.
 - TO INSIDE FACE OF EXCLUSIVE USE WASHROOMS.
 - SOME ARBITRARY LOCATIONS OF MEASUREMENT TERMINATION POINTS ARE NECESSARY DUE TO PECULIAR CIRCUMSTANCES.
 - SOME WALLS ARE SKEWED AND WOULD APPEAR TO BE THE ACTUAL EXTERIOR WALLS OF PREVIOUS PHASES OF DEVELOPMENT.
 - COMMON USE AREAS, INCLUDING HALLWAYS, SERVICE ROOMS, WASHROOMS AND STAIRWELLS ARE SHOWN FOR ILLUSTRATION PURPOSES ONLY AND SHOULD NOT BE CONSTRUED AS REPRESENTING CLASSIFICATION OF USE, OCCUPANCY OR FUNCTION.

Client:
 RENESAS
 603 March Rd., Ottawa, Canada

Project:
 AREA MEASUREMENTS

Drwg. Title:
 GROUND FLOOR

Reference Scale

Attention: Prints may not be to scale as shown (refer to Reference Scale to ensure accuracy when scaling).

Drwg#: A00
Scale: 1 : 100
Date: Mar 2015
Drawn: AE/KT
Reviewed: AE

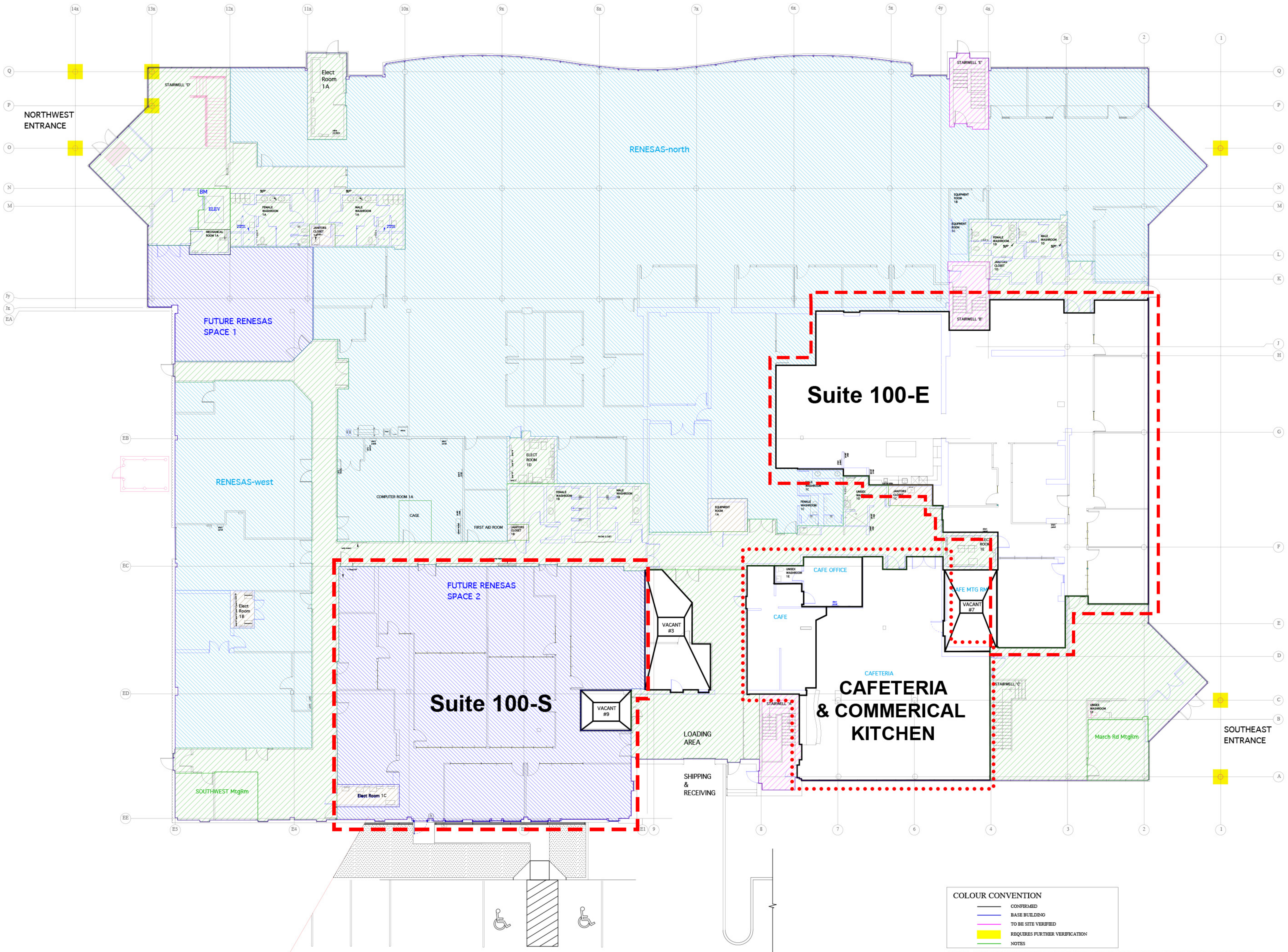

COLOUR CONVENTION

- CONFIRMED
- BASE BUILDING
- TO BE SITE VERIFIED
- REQUIRES FURTHER VERIFICATION
- NOTES

NOTE: FOR COMPLETE VERIFICATION, ITEMS SHOULD BE CROSS-REFERENCED WITH VERIFICATION OF EXTERIOR ENVELOPE, AND REFLECTED CEILING PLAN

NORTHWEST ENTRANCE

SOUTHEAST ENTRANCE

