

Integrity. Dedication. Professionalism.  
OFFICE SPACE FOR LEASE

# 880 Lady Ellen Place, Ottawa



## OFFICE SPACE FOR LEASE - OTTAWA WEST

**Price:** \$12.00/sf

**OPC:** \$15.54/sf

Available Immediately

**Suite G2 - 1,900 sf**

CONTACT:

613-759-8383

leasing@districtrealty.com

**Darren Clare**

Director, Leasing & Investment Sales  
Sales Representative

Ground floor office suite with air conditioning and plenty of beautiful natural light. Currently fitted with reception area, 3 private offices, and open space for work stations.

Conveniently located in Ottawa West with direct access to Carling Avenue and HWY 417. Ideal for commuters from Kanata. Plenty of parking for customers and tenants.

Close to many daily-use amenities and a variety of lunch options. Short walk to Carlington Park where employees can eat lunch outside.



1

880 Lady Ellen Place, Ottawa

District Realty Corporation Brokerage  
[districtrealty.com](http://districtrealty.com)

**DISTRICT  
REALTY**  
CORPORATION, BROKERAGE

The information as herewith enclosed has been obtained from sources we believe to be reliable, but we make no representation or warranties, express or implied, as to the accuracy of the information. All references to square footage and other information contained herein are approximate and subject to change. Prospective Purchasers/Tenants shall not construe the information as legal advice. All properties are subject to change or withdrawal without notice.



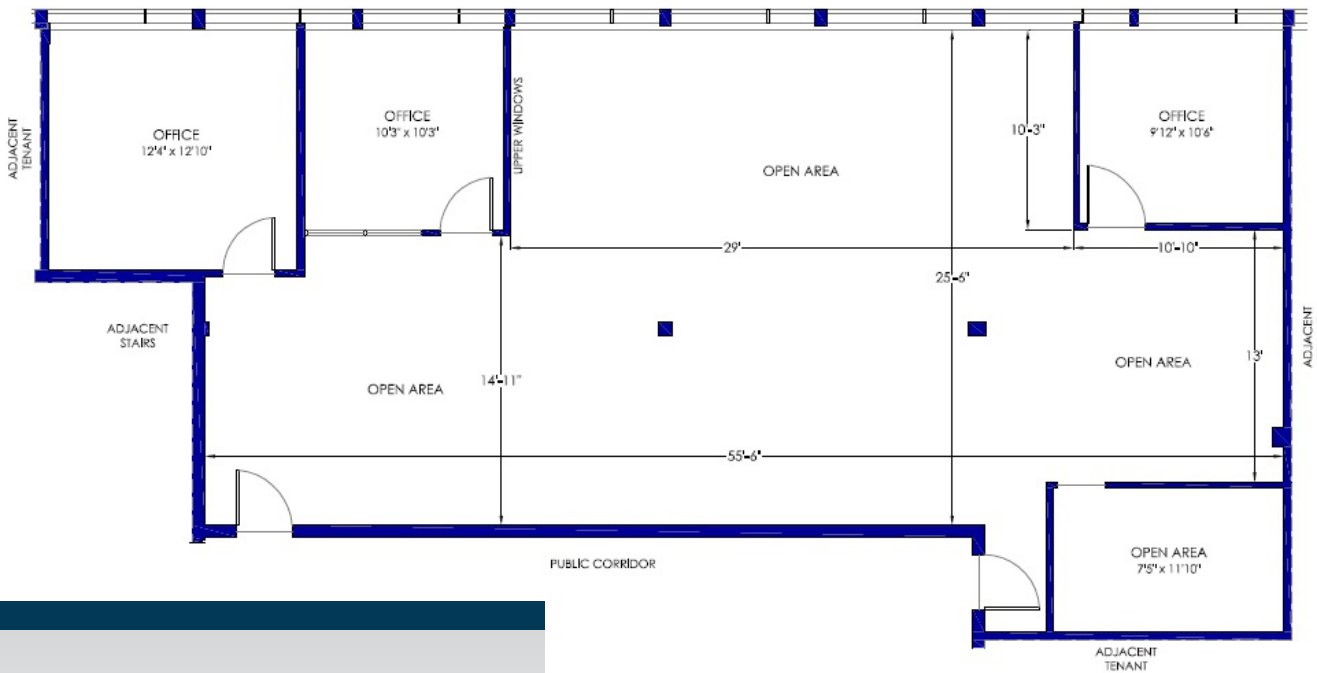

## CONTACT:

613-759-8383

leasing@districtrealty.com

**Darren Clare**

Director, Leasing & Investment Sales

## BUILDING HIGHLIGHTS

Easy access to HWY 417 | Parking ratio 1/per 500sf

Free parking for clients | Bus stops nearby

Building signage available