

LOWER LEVEL

145 SPRUCE STREET & 160-166 ELM STREET, OTTAWA, ON
(LEASE AREA ANALYSIS PLANS)

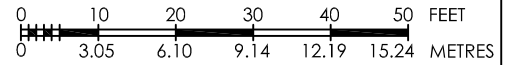

AERIAL VIEW



EXTERIOR VIEW

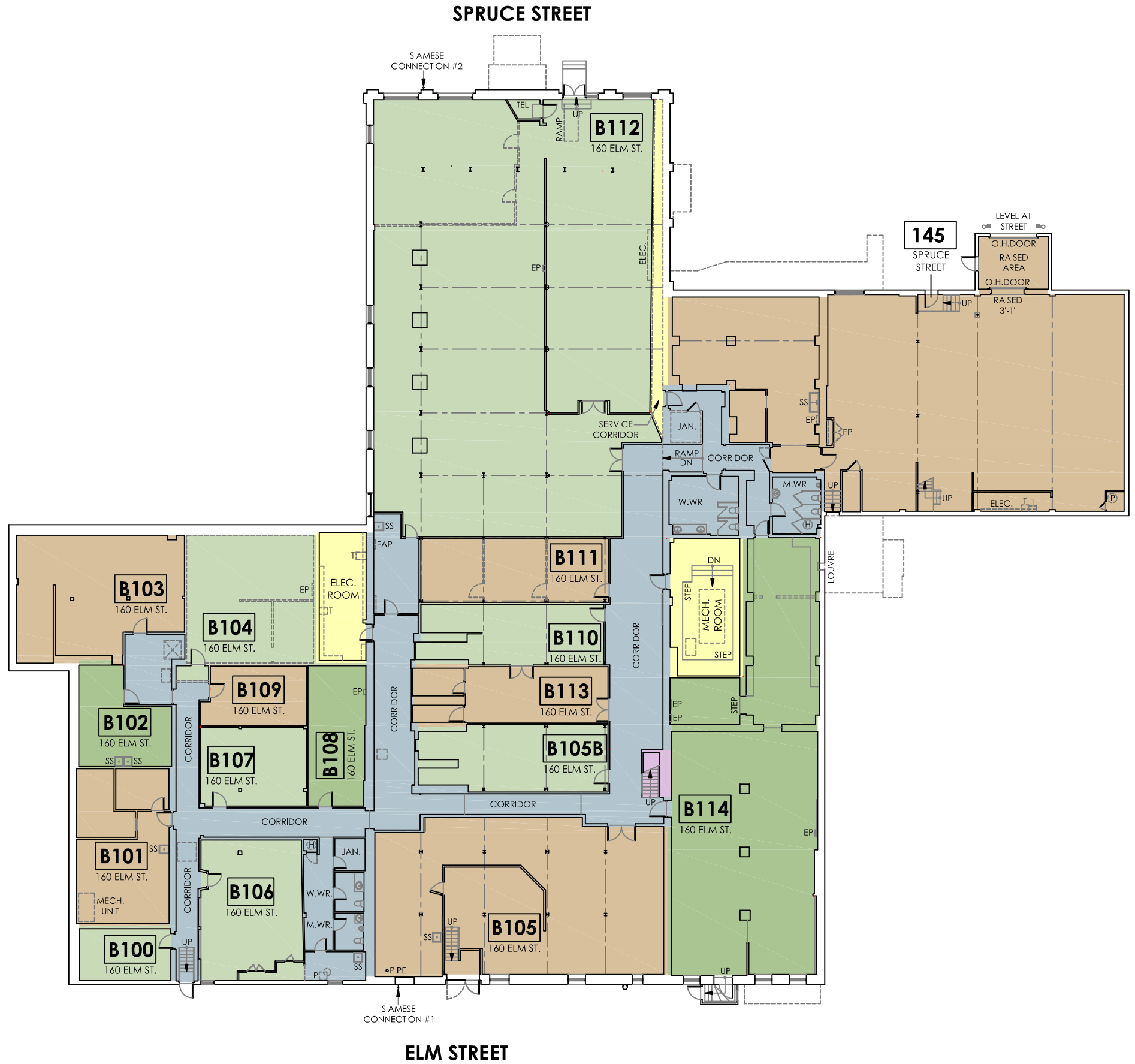

- LEGEND:**
- EXISTING WALLS
 - PROPOSED WALLS & DOORS
 - D.L. DOCK LEVELER
 - ELEC. ELECTRICAL
 - EP ELECTRICAL PANEL
 - HW HOT WATER TANK
 - T TRANSFORMER
 - TEL TELECOMMUNICATIONS

- SHADING LEGEND:**
- MAJOR VERTICAL PENETRATION
 - TENANT AREA 1
 - TENANT AREA 2
 - BUILDING COMMON AREA
 - FLOOR COMMON AREA
 - TENANT AREA 3
 - TENANT AREA 4

PREPARED FOR: District Realty Corporation Brokerage
ADDRESS: 145 Spruce St. & 160-166 Elm St. Ottawa, ON
DATE: June 2, 2016
REVISION: n/a
PROJECT NUMBER: 200081
DRAWING SCALE: 11" x 17" - Tabloid Size

NOTE: SOME AREAS WERE NOT ACCESSIBLE TO MEASUREMENT

